

Resolution No. 95-1

RESOLUTION OF THE LOCAL AGENCY FORMATION COMMISSION
OF THE COUNTY OF MENDOCINO
ADOPTING A SPHERE OF INFLUENCE AMENDMENT AND NEGATIVE DECLARATION
FOR THE DETACHMENT OF TERRITORY FROM THE MENDOCINO FIRE
PROTECTION DISTRICT INTO THE FORT BRAGG RURAL FIRE DISTRICT'S
SPHERE OF INFLUENCE AND APPROVAL OF THE NORTHEAST ANNEXATION
NO.2 TO THE FORT BRAGG RURAL FIRE DISTRICT (INCLUDING THE
DETACHMENT AREA) AND ACCEPTANCE OF A NEGATIVE DECLARATION

RESOLVED, by the Local Agency Formation Commission of the County of Mendocino, State of California, that

WHEREAS, a proposal for the annexation of certain territory to the Fort Bragg Rural Fire District hereinafter referred to as Northeast Annexation No.2 and a proposal for an amended Sphere of Influence for the detachment of territory from the Mendocino Fire Protection District to the Fort Bragg Rural Fire District's Sphere of Influence with a proposed Negative Declaration in the County of Mendocino has been filed with the Executive Officer of this Commission pursuant to Title 5, Division 3, commencing with Section 56000 of the Government Code; and

WHEREAS, the Executive Officer has reviewed the proposals and prepared reports, including her recommendation thereon and the final proposals and reports having been presented to and considered by this Commission; and

WHEREAS, this Commission called for and held a public hearing on the proposals on February 6, 1995 and at the hearing this Commission heard and received all oral and written protests, objections and evidence which were made, presented or filed, and all persons present were given an opportunity to hear and be heard with respect to this proposal and the report of the Executive Officer; and

WHEREAS, the Commission certifies that:

1. The Commission approves the Negative Declaration for the Sphere of Influence amendment for the detachment of territory from the Mendocino Fire Protection District into the Fort Bragg Rural Fire District's Sphere of Influence and to be filed with the County Clerk.

2. The Commission accepts the Negative Declaration approved by the Fort Bragg Rural Fire District on July 6, 1994 for the Annexation No.2 (including the detachment area) application.

NOW, THEREFORE, the Local Agency Formation Commission of the County of Mendocino DOES HEREBY RESOLVE, DETERMINE AND ORDER as follows:

1. The proposals being identified in the files of the Mendocino County Local Agency Formation Commission as File No. 93-4 also known under the distinctive short term designation as the Northeast Annexation No. 2 to the Fort Bragg Rural Fire District, for a Sphere of Influence Amendment for the detachment of territory from the Mendocino Fire Protection District into the Fort Bragg Rural Fire District's Sphere of Influence and the Northeast Annexation No.2 (including the detachment area) to the Fort Bragg Rural Fire District and the same are hereby approved subject to the following conditions and terms:

- a. The Negative Declaration be approved for the Sphere of Influence Amendment and is attached as Exhibit A; and,
- b. The Sphere of Influence to the Fort Bragg Rural Fire District is amended to include the territory from the Mendocino Fire Protection District as shown on the attached map marked Exhibit B; and,
- c. The Negative Declaration as adopted by the Fort Bragg Rural Fire District on July 6, 1994, for the Annexation No. 2 to the Fort Bragg Rural Fire District be accepted and is attached as Exhibit C (District application Exhibit F); and
- d. The territory includes 85 sq.miles, and is found to be inhabited, including the detachment area as set forth in the map and legal description and are hereby approved as submitted and are described in Exhibit D attached hereto and by this reference incorporated herein; and,
- e. The Benefit Assessment Ordinance No.84-01 approved by the Fort Bragg Rural Fire District on July 24, 1984, will be extended into this Northeast Annexation Area No.2.

2. The Fort Bragg Rural Fire District in the County of Mendocino is designated the Conducting Authority, and the Board of Directors of the Fort Bragg Rural Fire District are hereby authorized to conduct subsequent proceedings with a public hearing pursuant to Government Code Section 57000.

3. The Executive Officer is hereby authorized and directed to mail certified copies of this resolution as provided in Section 56853 of the Government Code.

Reso.#95-1

Page 3

ADOPTION of this Resolution was moved by Commissioner McMichael seconded by Commissioner Wasserman and carried on this 6th day of February, by the following roll call vote:

AYES: Pinches, McMichael, Alfano, Wasserman, Kollenborn
NOES: None
ABSENT: None
ABSTAIN: None

WHEREUPON, the Chairman declared the Resolution adopted, AND SO ORDERED.

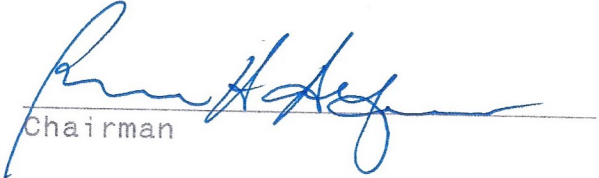
Chairman

ATTEST:

Executive Officer
STATE OF CALIFORNIA, County of Mendocino

by Mary Hiatt, Executive Officer, Local Agency Formation Commission in and for the County of Mendocino, State of California, do hereby certify the foregoing to be a full, true and correct copy of an order made by the Local Agency Formation Commission as the same appears spread upon their minute book.

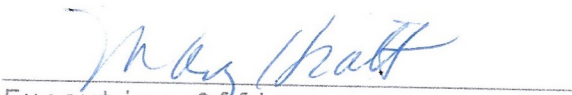
Executive Officer

LOCAL AGENCY FORMATION COMMISSION
OF MENDOCINO COUNTY

215 W. STANDLEY STREET
UKIAH, CA

NEGATIVE DECLARATION

For Review By Interested Agencies and the Public in Accordance with the Mendocino County Environmental Review Guidelines and the California Environmental Quality Act, an analysis has been made of possible environmental impacts of the following project by the Local Agency Formation Staff:

APPLICANT: Local Agency Formation Commission

PROJECT TITLE & DESCRIPTION: Sphere of Influence Amendment for the Detachment of territory along Caspar Creek from Mendocino Fire Protection District to the Fort Bragg Rural Fire District's Sphere of Influence for inclusion in the Northeast Annexation No.2 to the Fort Bragg Rural Fire District File# 93-4.

PROJECT LOCATION: Area along Caspar Creek forming the Northern boundary of the Mendocino Fire Protection District's Sphere of Influence.

FINDINGS WHICH SUPPORT A NEGATIVE DECLARATION: After conducting an Initial Study, the Lead Agency has determined that the project will not have a significant, substantial adverse effect on the environment for the following reasons:

1. The project will not have impacts which have the potential to degrade the quality of the environment or curtail the range of the environment.
2. The project will not have impacts which achieve short-term, to the disadvantage of long-term, environmental goals. A short-term impact on the environment is one which occurs in a relatively brief, definite period of time while long-term impacts will endure well into the future.

3. The project will not have impacts which are individually limited, but cumulatively considerable. A project may affect two or more separate resources where the impact of each resource is relatively small. If the effect of the total of those impacts on the environment is significant, and EIR must be prepared. This mandatory finding of significance does not apply to two or more separate projects where the impact of each is insignificant.
4. The environmental effects of a project will not cause substantial adverse effects on human beings, either directly or indirectly.

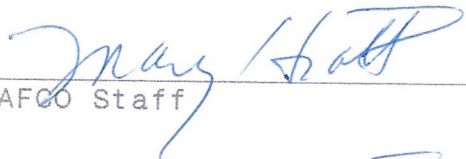

LAFCO Staff

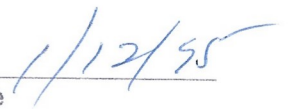

Date



Reviewed and Considered
by the Lead Agency

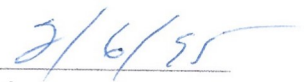

Date

PACIFIC OCEAN



FORT BRAGG RURAL
FIRE PROTECTION DIST.

AREA OF DETACHMENT
FROM

MENDOCINO FIRE
PROTECTION DISTRICT

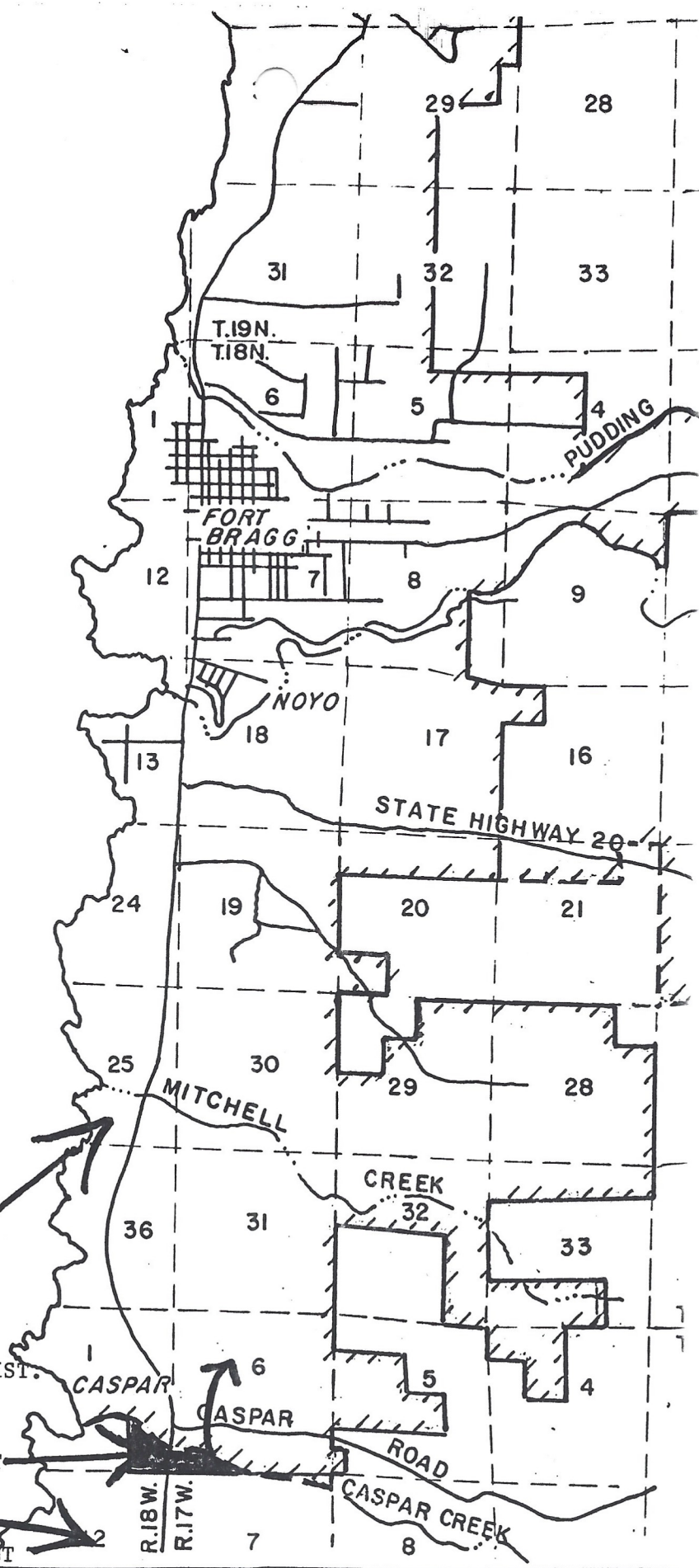

EXHIBIT F

**FORT BRAGG RURAL FIRE PROTECTION DISTRICT
141 N. MAIN STREET
FORT BRAGG, CALIFORNIA 95437**

NEGATIVE DECLARATION

For review by interested agencies and the public in accordance with the Mendocino County Environmental Review Guidelines and the California Environmental Quality Act, an analysis has been made of possible environmental impacts of the following project by the Fort Bragg Rural Fire Protection District.

APPLICANT/FILE NO.: Fort Bragg Rural Fire Protection District - No. 93-4

PROJECT TITLE & DESCRIPTION: Fort Bragg Rural Fire Protection District Northeast Annexation No. 2.

PROJECT LOCATION: North and East of the existing boundaries of the Fort Bragg Rural Fire Protection District.

Initial Study, the lead agency has determined that the project will not have a significant, substantial adverse effect on the environment for the following reasons:

1. The project will not have impacts which have the potential to degrade the quality of the environment or curtail the range of the environment.
2. The project will not have impacts which achieve short-term, to the disadvantage of long-term, environmental goals. A short-term impact on the environment is one which occurs in a relatively brief, definite period of time while long-term impacts will endure well into the future.
3. The project will not have impacts which are individually limited, but cumulatively considerable. A project may affect two or more separate resources where the impact of each resource is relatively small. If the effect of the total of those impacts on the environment is significant, an EIR must be prepared. This mandatory finding of significance does not apply to two or more separate projects where the impact of each is insignificant.
4. The environmental effects of a project will not cause substantial adverse effects on human beings, either directly or indirectly.

Negative Declaration (Continued)

Attached hereto is a copy of the Initial Study documenting reasons to support the above findings.

Leroy H Dunlap

LEROY DUNLAP

Chairman, Board of Directors
Fort Bragg Rural Fire Protection District

7-6-94

Date

May / Hall / Jaf co

Reviewed and Considered by the Lead Agency

Accepted

2/6/95

Date

MAP PREPARED BY: I. L. WELTY & ASSOCIATES
 703 NORTH MAIN STREET
 FORT BRAGG, CA. 95437
 PHONE: (707) 964-8865

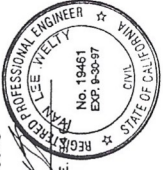

IVAN LEE WELTY R.C.E. REGISTERED PROFESSIONAL ENGINEER
 STATE OF CALIFORNIA

 EXISTING DISTRICT BOUNDARY

 ANNEXATION BOUNDARY

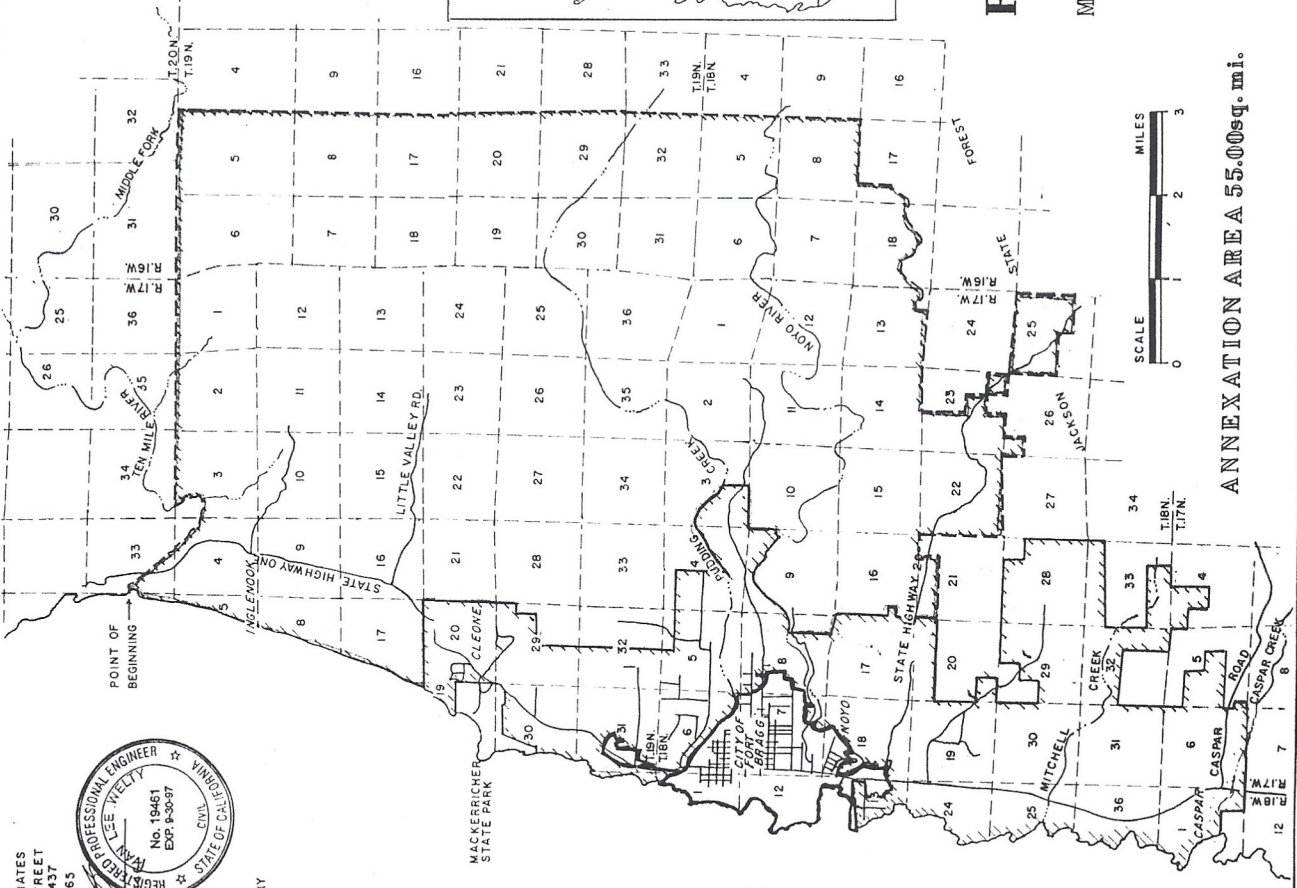

PACIFIC OCEAN



ANNEXATION AREA 55,000sq. mi.

Exhibit D of So. 95-1

ACCEPTANCE CERTIFICATE
 I, _____, CHAIRMAN OF THE LOCAL AGENCY FORMATION COMMISSION OF THE COUNTY OF MENDOCINO, STATE OF CALIFORNIA, HEREBY CERTIFY THAT SAID LOCAL AGENCY FORMATION COMMISSION, BY RESOLUTION, ON THE _____ DAY OF _____, 199____, APPROVED THE WITHIN MAP.

CHAIRMAN
 LOCAL AGENCY FORMATION COMMISSION

CERTIFICATE OF COMPLETION
 RECORDED _____, 199____, BOOK _____, PAGE _____

AUTHORIZATION CERTIFICATE
 I, _____, CHAIRMAN OF THE BOARD OF DIRECTORS OF THE FORT BRAGG RURAL FIRE DISTRICT, HEREBY CERTIFY THAT SAID BOARD OF DIRECTORS DID, BY RESOLUTION DATED _____, 199____, APPROVE THE WITHIN MAP.

CHAIRMAN
 FORT BRAGG RURAL FIRE DISTRICT

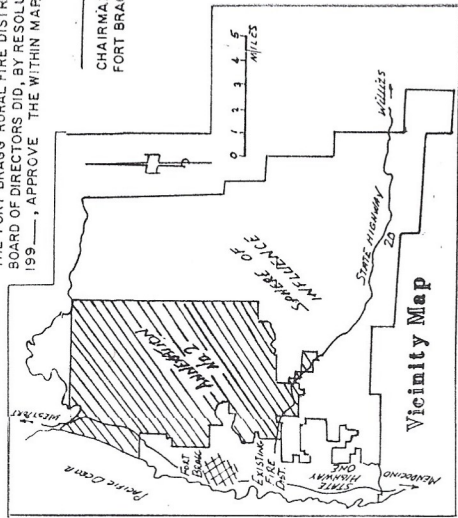

**NORTHEAST
 ANNEXATION NO. 2
 FORT BRAGG RURAL FIRE
 DISTRICT**

Mendocino County, California

June, 1994

Laeco File No. 93-4

EXHIBIT "B"

10/15/94

EXHIBIT "A"

NORTHEAST ANNEXATION NO. 2

TO THE FORT BRAGG

RURAL FIRE DISTRICT

LAFCO FILE NO. 93-4

ALL THAT CERTAIN REAL PROPERTY SITUATED IN THE COUNTY OF MENDOCINO, STATE OF CALIFORNIA LYING AND BEING WITHIN MOUNT DIABLO BASE AND MERIDIAN TOWNSHIP SUBDIVISION; MORE PARTICULARLY DESCRIBED AS FOLLOWS:

BEGINNING AT THE INTERSECTION OF THE MEAN HIGH TIDE LINE OF THE PACIFIC OCEAN AND THE NORTHEASTERLY BANK OF THE TEN MILE RIVER; THENCE FROM SAID POINT OF BEGINNING, EASTERLY, ALONG SAID BANK OF THE TEN MILE RIVER TO THE NORTH LINE OF SECTION 3, TOWNSHIP 19 NORTH, RANGE 17 WEST; THENCE EASTERLY ALONG THE NORTH LINES OF SECTIONS 3, 2 AND 1 OF TOWNSHIP 19 NORTH, RANGE 17 WEST, AND SECTIONS 6 AND 5 OF TOWNSHIP 19 NORTH, RANGE 16 WEST, TO THE NORTHEAST CORNER OF SAID SECTION 5; THENCE SOUTHERLY ALONG THE EAST LINES OF SECTIONS 5, 8, 17, 20, 29 AND 32, TOWNSHIP 19 NORTH, RANGE 16 WEST, TO THE NORTHEAST CORNER OF SECTION 5, TOWNSHIP 18 NORTH, RANGE 16 WEST; THENCE CONTINUING SOUTHERLY ALONG THE EAST LINE OF SECTIONS 5 AND 8, TOWNSHIP 18 NORTH, RANGE 16 WEST, TO THE SOUTHEAST CORNER OF SAID SECTION 8; THENCE WESTERLY ALONG THE SOUTHERLY LINE OF SAID SECTION 8, TO THE NORTHEAST CORNER OF THE WEST HALF OF THE NORTHWEST QUARTER OF SECTION 17, TOWNSHIP 18 NORTH, RANGE 16 WEST; THENCE ALONG THE BOUNDARIES OF JACKSON STATE FOREST AS SHOWN AND DELINEATED ON THAT CERTAIN RECORD OF SURVEY FILED IN MAP CASE 2, DRAWER 12, PAGE 70, MENDOCINO COUNTY RECORDS,

AS FOLLOWS, SOUTH 00°52'21 "WEST, 2518.07 FEET; THENCE NORTH 88°40'16" WEST, 507.23 FEET; THENCE SOUTH 14°00' WEST, 588.06 FEET; THENCE NORTH 73°00' WEST 403.92 FEET; THENCE NORTH 83°00' WEST, 273.48 FEET; THENCE NORTH 73°45' WEST, 434.28 FEET; THENCE SOUTH 62°00' WEST, 429.00 FEET; THENCE SOUTH 47°30' WEST, 948.42 FEET; THENCE SOUTH 07°00' WEST, 55.76 FEET; THENCE NORTH 87°55'34" WEST, 823.86 FEET; THENCE NORTH 60°30' WEST, 752.29 FEET; THENCE NORTH 36°30' WEST, 417.12 FEET; THENCE NORTH 54°15' WEST, 537.90 FEET; THENCE NORTH 83°00' WEST, 363.00 FEET; THENCE SOUTH 33°30' WEST, 578.82 FEET; THENCE SOUTH 53°30' WEST, 447.48 FEET; THENCE SOUTH 28°30' WEST, 714.12 FEET; THENCE SOUTH 28°30' WEST, 312.43 FEET; THENCE NORTH 33° WEST, 389.11 FEET; THENCE NORTH 61°30' WEST, 961.40 FEET; THENCE SOUTH 00°47'07" WEST, 1149.72 FEET TO THE SOUTHERLY LINE OF SECTION 13, TOWNSHIP 18 NORTH, RANGE 17 WEST; THENCE WESTERLY ALONG THE SOUTHERLY BOUNDARY OF SAID SECTION 13 AND ALONG THE NORTHERLY BOUNDARY OF SECTION 23, TOWNSHIP 18 NORTH, RANGE 17 WEST, TO THE NORTH QUARTER CORNER OF SAID SECTION 23; THENCE SOUTHERLY TO THE CENTER QUARTER CORNER OF SAID SECTION 23; THENCE EASTERLY TO THE CENTER EAST SIXTEENTH CORNER OF SAID SECTION 23; THENCE SOUTHERLY TO THE SOUTHEAST SIXTEENTH CORNER OF SAID SECTION 23; THENCE EASTERLY ALONG THE NORTHERLY LINE OF THE SOUTHEAST QUARTER OF THE SOUTHEAST QUARTER OF SAID SECTION 23, TO THE EAST LINE OF SAID SECTION 23; THENCE SOUTHERLY ALONG THE EASTERLY LINE OF SAID SECTION 23, TO THE SOUTHEAST CORNER THEREOF; THENCE EASTERLY ALONG THE NORTHERLY LINE OF SECTION 25, TOWNSHIP 18 NORTH, RANGE 17 WEST, TO THE NORTHEAST CORNER OF SAID SECTION 25; THENCE SOUTHERLY ALONG THE EASTERLY LINE OF SAID SECTION 25 TO THE

SOUTHEAST CORNER OF THE NORTH HALF OF THE SOUTHEAST QUARTER OF SAID SECTION 25; THENCE WESTERLY ALONG THE SOUTHERLY LINE OF SAID NORTH HALF OF THE SOUTHEAST QUARTER TO THE SOUTHWEST CORNER THEREOF; THENCE NORTHERLY ALONG THE WESTERLY LINE OF SAID NORTH HALF OF THE SOUTHEAST QUARTER TO THE CENTER QUARTER CORNER OF SAID SECTION 25; THENCE WESTERLY TO THE WEST QUARTER CORNER OF SAID SECTION 25; THENCE NORTHERLY TO THE NORTHWEST CORNER OF SAID SECTION 25; THENCE WESTERLY ALONG THE SOUTHERLY LINE OF THE SOUTHEAST QUARTER OF THE SOUTHEAST QUARTER OF SECTION 23, TOWNSHIP 18 NORTH, RANGE 17 WEST, TO THE SOUTHWEST CORNER THEREOF; THENCE NORTHERLY TO THE SOUTHEAST SIXTEENTH CORNER OF SAID SECTION 23; THENCE WESTERLY TO THE CENTER SOUTH SIXTEENTH CORNER OF SAID SECTION 23; THENCE SOUTHERLY TO THE SOUTH QUARTER CORNER OF SAID SECTION 23; THENCE WESTERLY ALONG THE SOUTHERLY LINE OF SECTION 23, TO THE NORTHEAST CORNER OF THE NORTHWEST QUARTER OF THE NORTHWEST QUARTER OF SECTION 26; THENCE SOUTHERLY ALONG THE EAST LINE OF THE SAID NORTHWEST QUARTER OF THE NORTHWEST QUARTER OF SECTION 26, TO THE SOUTHEAST CORNER THEREOF; THENCE WESTERLY ALONG THE SOUTHERLY LINE OF SAID NORTHWEST QUARTER OF THE NORTHWEST QUARTER OF SECTION 26, TO THE WEST LINE OF SAID SECTION 26; THENCE NORTHERLY ALONG THE WESTERLY LINE OF SAID SECTION 26, TO THE SOUTHEAST CORNER OF SECTION 22, TOWNSHIP 18 NORTH, RANGE 17 WEST; THENCE WESTERLY ALONG THE SOUTHERLY LINE OF SAID SECTION 22 TO THE SOUTHWEST CORNER THEREOF; THENCE NORTHERLY ALONG THE WESTERLY LINE OF SAID SECTION 22, TO THE NORTHEAST CORNER OF SECTION 21, TOWNSHIP 18 NORTH, RANGE 17 WEST; THENCE WESTERLY ALONG THE NORTHERLY LINE OF SAID SECTION 21, TO THE NORTHWEST CORNER OF THE NORTHEAST QUARTER OF THE NORTHEAST QUARTER OF SAID

SECTION 21; THENCE SOUTHERLY ALONG THE WESTERLY LINE OF SAID NORTHEAST QUARTER OF THE NORTHEAST QUARTER OF SECTION 21, TO THE SOUTHWEST CORNER THEREOF; THENCE WESTERLY ALONG THE SOUTHERLY LINE OF THE NORTH HALF OF THE NORTH HALF OF SAID SECTION 21, TO THE SOUTHEAST CORNER OF THE NORTHEAST QUARTER OF THE NORTHEAST QUARTER OF SECTION 20, TOWNSHIP 18 NORTH, RANGE 17 WEST AND THE BOUNDARY OF THE WILLITS ROAD ANNEXATION TO FORT BRAGG RURAL FIRE PROTECTION DISTRICT; THENCE NORTHERLY ALONG THE EAST LINE OF SAID SECTION 20 AND THE EAST LINE OF SECTION 17, TOWNSHIP 18 NORTH, RANGE 17 WEST TO A POINT APPROXIMATELY 1320 FEET NORTH OF THE SOUTHEAST CORNER OF SAID SECTION 17; THENCE CONTINUING ALONG THE BOUNDARIES OF THE WILLITS ROAD ANNEXATION TO THE FORT BRAGG RURAL FIRE PROTECTION DISTRICT, EASTERLY 436 FEET; THENCE NORTHERLY 416 FEET; THENCE WESTERLY 436 FEET; TO THE EAST LINE OF SAID SECTION 17; THENCE NORTH TO THE NORTHEAST CORNER OF SAID SECTION 17; THENCE WEST TO THE SOUTHEAST CORNER OF THE WEST HALF OF THE SOUTHEAST QUARTER OF SECTION 8, TOWNSHIP 18 NORTH, RANGE 17 WEST; AND THE BOUNDARY OF FORT BRAGG RURAL FIRE DISTRICT AS DESCRIBED IN "EXHIBIT A" OF THE FORT BRAGG RURAL FIRE DISTRICT, RECORDED IN BOOK 543 OF OFFICIAL RECORDS OF MENDOCINO COUNTY, PAGE 12; THENCE ALONG SAID BOUNDARY OF THE FORT BRAGG RURAL FIRE DISTRICT AS FOLLOWS:

THENCE NORTHERLY ALONG THE EAST LINE OF SAID WEST HALF OF THE SOUTHEAST QUARTER OF SAID SECTION 8 TO THE CENTER OF THE CHANNEL OF THE NOYO RIVER; THENCE SOUTHEASTERLY, NORTHEASTERLY, AND EASTERLY, UPSTREAM ALONG SAID CENTER OF THE CHANNEL OF THE NOYO RIVER TO A POINT ON THE SOUTHERLY LINE OF THE LANDS OF MADSEN, SAID LANDS DESCRIBED IN BOOK 226 OF OFFICIAL RECORD OF MENDOCINO COUNTY, PAGE

499; THENCE CONTINUING ALONG SAID BOUNDARY OF THE FORT BRAGG RURAL FIRE DISTRICT AND ALONG THE SOUTHERLY BOUNDARY OF SAID LANDS OF MADSEN AS FOLLOWS: SOUTH 71°30' EAST, 588.00 FEET MORE OR LESS; THENCE NORTH 45°30' EAST, 50.00 FEET MORE OR LESS; THENCE NORTH 58°30' EAST, 265.00 FEET MORE OR LESS; THENCE NORTH 28°30' EAST, 200.00 FEET TO THE SOUTH LINE OF THE NORTH HALF OF THE NORTHEAST QUARTER OF SECTION 9, TOWNSHIP 18 NORTH, RANGE 17 WEST; THENCE LEAVING THE LANDS OF MADSEN AND CONTINUING ALONG THE BOUNDARY OF SAID FORT BRAGG RURAL FIRE DISTRICT, EASTERLY, 185 FEET, MORE OR LESS TO THE SOUTHEAST CORNER OF THE NORTH HALF OF THE NORTHEAST QUARTER OF SAID SECTION 9; THENCE NORTHERLY ALONG THE EAST LINE OF SAID SECTION 9 TO THE NORTHEAST CORNER THEREOF AND THE SOUTHEAST CORNER OF SECTION 3, TOWNSHIP 18 NORTH, RANGE 17 WEST; THENCE EASTERLY TO THE SOUTHEAST CORNER OF THE WEST HALF OF SAID SECTION 3; THENCE NORTHERLY ALONG THE EAST LINE OF THE WEST HALF OF SAID SECTION 3 TO THE CENTER OF PUDDING CREEK; THENCE FOLLOWING THE CENTER OF PUDDING CREEK WESTERLY THROUGH SECTION 3 AND 4, TOWNSHIP 18 NORTH, RANGE 17 WEST, TO THE EAST LINE OF THE WEST HALF OF SAID SECTION 4; THENCE CONTINUING ALONG THE BOUNDARY OF THE FORT BRAGG RURAL FIRE DISTRICT, NORTHERLY TO THE NORTHEAST CORNER OF THE SOUTH HALF OF THE NORTHWEST QUARTER OF SAID SECTION 4; THENCE WESTERLY ALONG THE NORTH LINE OF SAID SOUTH HALF OF THE NORTHWEST QUARTER OF SECTION 4 AND THE NORTH LINE OF THE SOUTH HALF OF THE NORTHEAST QUARTER OF SECTION 5, TOWNSHIP 18 NORTH, RANGE 17 WEST TO THE NORTHWEST CORNER THEREOF; THENCE NORTHERLY TO THE NORTHEAST CORNER OF THE NORTHWEST QUARTER OF SAID SECTION 5 AND THE SOUTHEAST CORNER OF THE WEST HALF OF SECTION 32, TOWNSHIP 19 NORTH, RANGE 17 WEST;

THENCE NORTHERLY TO THE SOUTHEAST CORNER OF THE SOUTHWEST QUARTER OF SECTION 29, TOWNSHIP 19 NORTH, RANGE 17 WEST; THENCE NORTHERLY TO THE NORTHEAST CORNER OF SAID SOUTHWEST QUARTER OF SECTION 29; THENCE EASTERLY TO THE SOUTHEAST CORNER OF THE WEST HALF OF THE EAST HALF OF THE SOUTHEAST QUARTER OF THE NORTHEAST QUARTER OF SAID SECTION 29; THENCE NORTHERLY TO THE NORTHEAST CORNER OF THE WEST HALF OF THE EAST HALF OF THE SOUTHEAST QUARTER OF THE NORTHEAST QUARTER OF SAID SECTION 29; THENCE EASTERLY TO THE SOUTHEAST CORNER OF THE NORTHEAST QUARTER OF THE NORTHEAST QUARTER OF SAID SECTION 29; THENCE NORTHERLY ALONG THE EAST LINE OF SAID SECTION 29 TO THE SOUTHEAST CORNER OF SECTION 20, TOWNSHIP 19 NORTH, RANGE 17 WEST; THENCE NORTHERLY TO THE NORTHEAST CORNER OF SAID SECTION 20; THENCE WESTERLY ALONG THE NORTH LINE OF SAID SECTION 20 AND THE NORTH LINE OF SECTION 19, TOWNSHIP 19 NORTH, RANGE 17 WEST TO THE MEAN HIGH TIDE LINE OF THE PACIFIC OCEAN; THENCE LEAVING THE BOUNDARY OF THE FORT BRAGG RURAL FIRE DISTRICT, NORTHERLY ALONG SAID MEAN HIGH TIDE LINE TO THE POINT OF BEGINNING.

ANNEXATION AREA= 55.00 SQUARE MILES

DESCRIPTION PREPARED BY :

I.L. WELTY & ASSOCIATES
703 A NORTH MAIN STREET
FORT BRAGG, CA 95437





IVAN LEE WELTY, R.C.E., 19461