

Resolution No. 17-18-01
of the Local Agency Formation Commission of Mendocino County
Approving the
Corrected Annexation Map for the North of Ten Mile River Annexation to the
Fort Bragg Rural Fire Protection District
LAFCo File No. A-2012-8004

WHEREAS, the North of Ten Mile River Annexation to the Fort Bragg Rural Fire Protection District was approved subject to terms and conditions set forth in Mendocino LAFCo Resolution No. 12-13-04 adopted on May 6, 2013 and attached hereto; and

WHEREAS, the North of Ten Mile River Annexation to the Fort Bragg Rural Fire Protection District was ordered by the Commission on September 3, 2013 following a protest hearing in Fort Bragg, California on July 31, 2013; and

WHEREAS, a Certificate of Completion (Document 2014-06683) was filed with the Mendocino County Recorder on June 12, 2014; and

WHEREAS, the Board of Equalization acknowledged submittal of complete and accurate documentation of the annexation on July 9, 2014; and

WHEREAS, the County of Mendocino subsequently identified base map notes and boundary lines on the approved map that erroneously identified several parcels as falling within the District's previously existing boundaries (APNs 015-140-85, 015-140-022, and 015-140-87); and

WHEREAS, the map corrections are made to the base mapping and do not alter the area of annexation, and therefore no map correction with the Board of Equalization is necessary; and

WHEREAS, the map corrections are necessary to ensure an accurate administrative record for Mendocino LAFCo, the County of Mendocino, and the Fort Bragg Rural Fire Protection District; and.

WHEREAS, the boundary of the annexation territory and existing District boundary is correctly defined in map form attached hereto as Exhibit A, and by legal description attached hereto as Exhibit B.

NOW, THEREFORE, the Local Agency Formation Commission of Mendocino County does hereby RESOLVE, DETERMINE, and ORDER as follows:

1. The terms and conditions of the LAFCo Resolution 12-13-04 approving the North of Ten Mile River Annexation remain in effect and no changes to the adopted conditions and terms of approval are necessary.
2. The corrected annexation map is hereby approved as shown in Exhibit A and Exhibit B, attached hereto, and replaces the annexation map dated May 2013 and attached to Resolution No. 12-13-04.

The foregoing Resolution was passed and duly adopted at a regular meeting of the Mendocino Local Agency Formation Commission held on this 2nd day of October 2017, by the following vote:

AYES: (7) Brown, Doble, Gonzalez, Hamburg, McNerlin, Orth, and Ward

NOES: none

ABSTAIN: none

ABSENT: none

ATTEST:



UMA HINMAN, Executive Officer

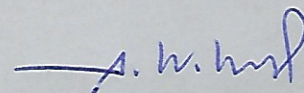

GERALD WARD, Chair



LEGEND

- EXISTING FORT BRAGG RURAL FIRE PROTECTION DISTRICT BOUNDARY AND APPROXIMATE CENTERLINE OF TEN MILE RIVER
- PROPOSED FORT BRAGG RURAL FIRE PROTECTION DISTRICT BOUNDARY
- AREA TO BE ANNEXED TO THE FORT BRAGG RURAL FIRE PROTECTION DISTRICT - 1,200 ACRES ±
- COURSE NUMBER MATCHING THE WRITTEN GEOGRAPHIC DESCRIPTION, SEE SHEET 2

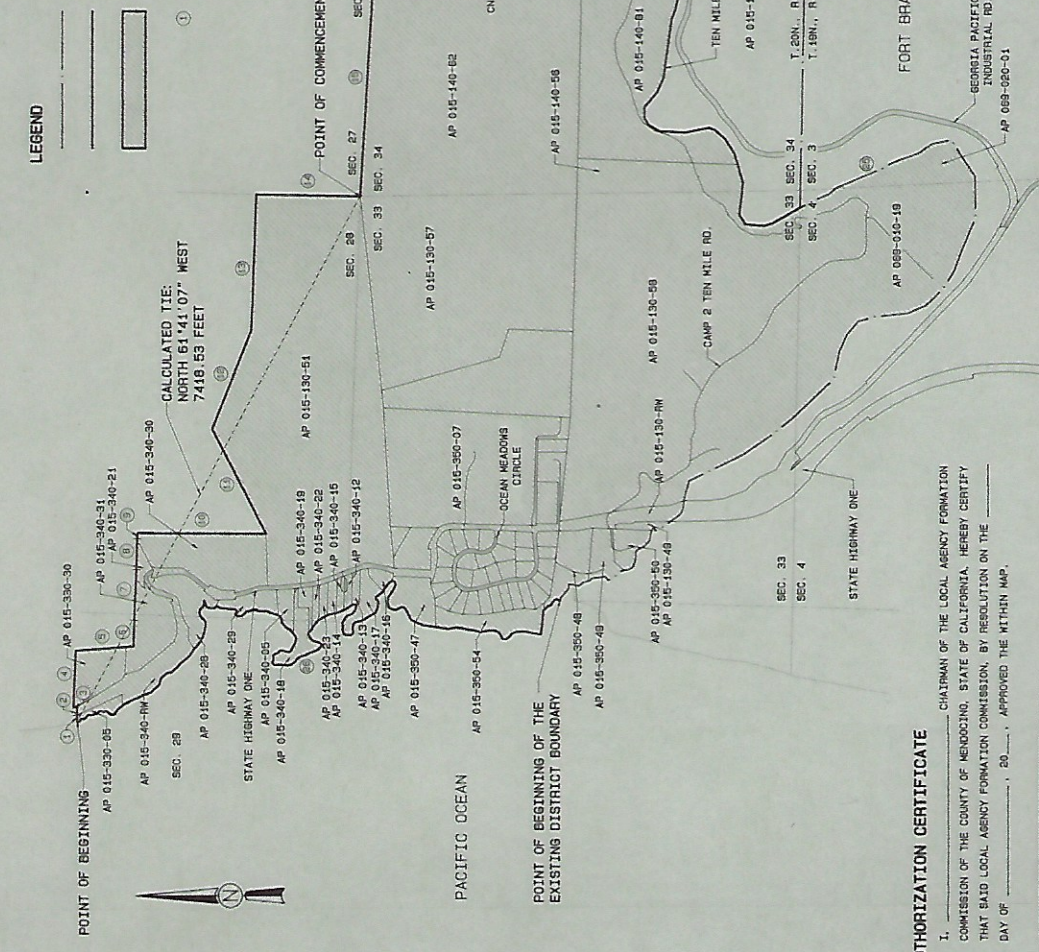

LAFCO MAP

OF

NORTH OF TEN MILE RIVER ANNEXATION TO THE FORT BRAGG RURAL FIRE PROTECTION DISTRICT LAFCO FILE NUMBER A-2012-04

MENDOCINO COUNTY, CALIFORNIA
 JULY 2017
 SHEET 1 OF 2
 413021

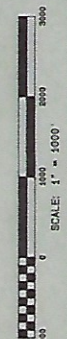

SAW
 CONSULTING ENGINEERS & GEOLOGISTS
 335 SOUTH MAIN STREET (707)459-4518
 WILDS, CA 95490 FAX (707)459-1864

AUTHORIZATION CERTIFICATE

I, _____ CHAIRMAN OF THE LOCAL AGENCY FORMATION COMMISSION OF THE COUNTY OF MENDOCINO, STATE OF CALIFORNIA, HEREBY CERTIFY THAT SAID LOCAL AGENCY FORMATION COMMISSION, BY RESOLUTION ON THE DAY OF _____, 20____, APPROVED THE WITHIN MAP.

CHAIRMAN LOCAL AGENCY FORMATION COMMISSION

CERTIFICATE OF COMPLETION

RECORDED _____, 20____, AS INST. NO. _____
 MENDOCINO COUNTY RECORDS.

DISCLAIMER

FOR ASSESSMENT PURPOSES ONLY. THIS DESCRIPTION OF LAND IS NOT A LEGAL PROPERTY DESCRIPTION AS DEFINED IN THE SUBDIVISION MAP ACT AND MAY NOT BE USED AS THE BASIS FOR AN OFFER FOR SALE OF THE LAND DESCRIBED.

COURSES

All that real property located in Sections 28, 29, 33, 34, & 35 in Township 20 North, and Sections 3 & 4 in Township 19 North, Range 17 West, Mount Diablo Baseline and Meridian, in the unincorporated portion of Mendocino County, California, described as follows:

Commencing at the Section Corner common to Sections 27, 28, 33 and 34; Thence North 61°41'07" West 7418.63 feet to the POINT OF BEGINNING said point being the intersection of the mean high tide line of the Pacific Ocean and the northerly line of that parcel conveyed by Deed recorded as Document 2002-19590, Official Records of Mendocino County (O.R.);

- 1) Thence, along said northerly line, East 81.00 feet to the westerly line of California State Route 1.
- 2) Thence East 104.59 feet to the easterly line of said State Route.
- 3) Thence, along said easterly line, North 07°02'00" West 49.47 feet to the northwesterly corner of that parcel conveyed by Deed recorded as Document 2008-13178, O.R.;
- 4) Thence, along the northerly line of said parcel, South 87°57'30" East 705.17 feet to the northeasterly corner of said parcel;
- 5) Thence, along the easterly line of said parcel, South 04°48'21" East 714.45 feet to the northerly line of that parcel conveyed by Deed recorded in Book 2422, Page 43 O.R.; Thence, along said northerly line, the following two courses:
 - 6) South 87°57'30" East 325.84 feet;
 - 7) South 87°48'50" East 658.00 feet to the northwesterly corner of that parcel conveyed by Deed recorded as Document 1998-19699 O.R.; Thence, along the northerly line of said parcel, and the northerly line of the parcel conveyed by Deed recorded in Book 1994, Page 465 O.R. (Parcel Two), the following two courses, respectively:
 - 8) South 87°48'50" East 391.00 feet;
 - 9) South 87°48'50" East 70.45 feet to the northeasterly corner of said parcel;
 - 10) Thence, along the easterly line of said parcel, South 00°17'51" West 1695.31 feet to the northerly line of that parcel conveyed by Deed recorded in Book 1848, Page 340 O.R.; Thence, along the northwesterly, northeasterly, and northerly lines of said parcel, the following three courses:
 - 11) North 62°55'35" East 1459.61 feet;
 - 12) South 68°59'37" East 1335.21 feet;
 - 13) South 87°47'48" East 4686.02 feet to the northwesterly corner of said parcel;
 - 14) Thence, along the easterly line of said parcel, being the line common to Sections 27 and 28, South 00°57'34" West 1288.43 feet to the corner common to Sections 27, 28, 33 and 34;
 - 15) South 86°35'33" East 2569.52 feet to the 1/4 corner common to said Sections 27 and 34;
 - 16) South 01°31'47" West 1269.96 feet to the NE 1/16 corner of said Section 34;
 - 17) South 86°42'23" East 1230.94 feet to the NE 1/16 corner of said Section 34;
 - 18) South 01°14'57" West 1242.03 feet to the SE 1/16 corner of said Section 34;
 - 19) Thence, South 84°55'43" East 1316.23 feet to the 1/4 corner common to said Section 34 and 35;
 - 20) Thence, along the line common to Sections 34 and 35, South 02°04'20" West 1281.46 feet;
 - 21) Thence, leaving said common line, South 86°57'40" East 905.40 feet;
 - 22) Thence North 85°40'20" East 482.35 feet to the line dividing the East 1/2 and West 1/2 of the South West 1/4 of Section 35;
 - 23) Thence along said line, North 01°50'20" East 991.62 feet to the East-West centerline of Section 35;
 - 24) Thence, along said centerline, South 86°38'40" East to the centerline of the fork commonly known as the Middle Fork of Ten Mile River and the existing boundary of the Fort Bragg Rural Fire Protection District;
 - 25) Thence along the centerline of said fork of river and Ten Mile River, generally in a westerly direction, and the northerly boundary of the Fort Bragg Rural Fire Protection District to the intersection of the mean high tide line of the Pacific Ocean;
 - 26) Thence, generally in a northerly direction, along said mean high tide line to the Point of Beginning and the end of the description of the parcels to be annexed, containing 1,200 acres, more or less.

LAFCO MAP
OF

**NORTH OF TEN MILE RIVER
ANNEXATION TO THE FORT BRAGG
RURAL FIRE PROTECTION DISTRICT
LAFCO FILE NUMBER A-2012-04**

MENDOCINO COUNTY, CALIFORNIA
SCALE: 1" = 1000 ±
JULY 2017

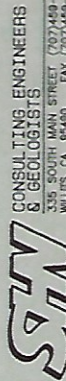

335 SOUTH MAIN STREET (707)459-4518
WILLIS, CA 95960 FAX: (707)459-1884

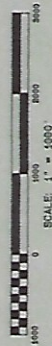

DISCLAIMER
FOR ASSESSMENT PURPOSES ONLY. THIS DESCRIPTION OF LAND IS NOT A LEGAL PROPERTY DESCRIPTION AS DEFINED IN THE SURVEYING MAP ACT, AND MAY NOT BE USED AS THE BASIS FOR AN OFFER FOR SALE OF THE LAND DESCRIBED.